



The Corniche

23 Albert Embankment, SE1 7GG

£1,695 Per Week



Floor Plan

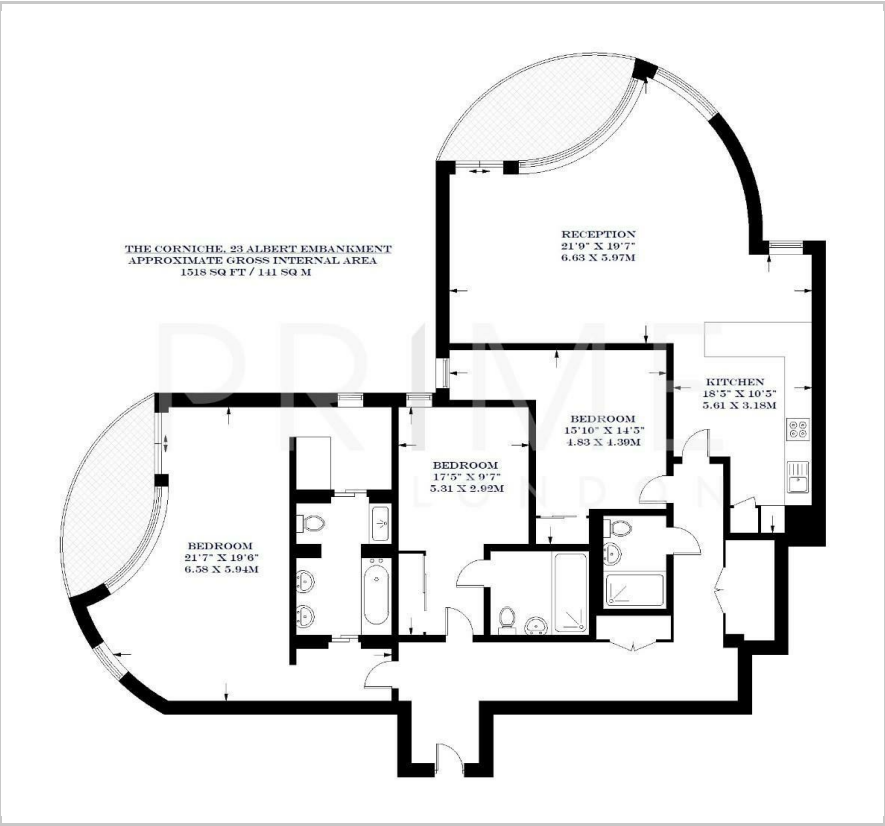

Area Map



Energy Efficiency Graph

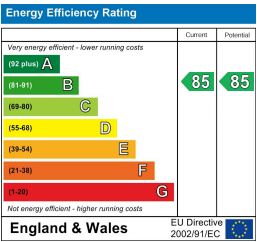

Viewing

By appointment. Contact us on 0207 928 6663 if you wish to arrange a viewing appointment for this property, or require further information.

- Three bedroom three bathroom apartment
- Two river facing balconies
- Fully furnished
- Underground parking space
- Residents gym, spa, and pool
- 19th floor bar and Sky Lounge
- 24 hour concierge



A bright and modern river facing 1,518 sq ft / 141 sq m three bedroom apartment with balcony, available to rent through Prime London in The Corniche, 23 Albert Embankment. The property comes fully furnished and with a secure underground parking space.

Comprising large open plan reception and kitchen leading to a private balcony with views of the River Thames and The Houses of Parliament, three double bedrooms with ample storage, three bathrooms, two of which are en suite, and further storage in the hall. The primary bedroom also has a dressing area and its own private river facing balcony.

Located in an enviable position on the bank of the River Thames, The Corniche (designed by Foster & Partners) captures some of London's most exquisite views, not only of the Houses of Parliament and the River Thames, but also the Tate Britain, London Eye and the City. The development includes extensive residents facilities including a restaurant, gym, spa, pool and cinema, and also commercial spaces such as restaurants and cafes focused around a well considered and inviting public space.



These particulars, whilst believed to be accurate are set out as a general outline only for guidance and do not constitute any part of an offer or contract. Intending purchasers should not rely on them as statements of representation of fact, but must satisfy themselves by inspection or otherwise as to their accuracy. No person in this firm's employment has the authority to make or give any representation or warranty in respect of the property.